

# ASPECT

N I S E K O

## APARTMENT 102

FLOOR AREA  
168.77m<sup>2</sup> (inc. 2.79m<sup>2</sup> owner storage)

TERRACE  
33.7m<sup>2</sup> (Exclusive use non-saleable area)

PARKING  
Non-reserved; subject to availability

LAYOUT  
3 bedrooms / 3 bathrooms / 1 Maids room

VIEWS  
Mt Yotei



NORTH



MT. YOTEI

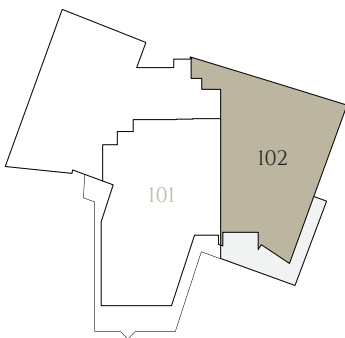

# ASPECT

N I S E K O

## APARTMENT 202

FLOOR AREA  
167.23m<sup>2</sup> (inc. 2.79m<sup>2</sup> owner storage)

BALCONY  
6.6m<sup>2</sup> (Exclusive use non-saleable area)

PARKING  
Non-reserved; subject to availability

LAYOUT  
3 bedrooms / 3 bathrooms / 1 Maids room

VIEWS  
Mt Yotei



NORTH



MT. YOTEI

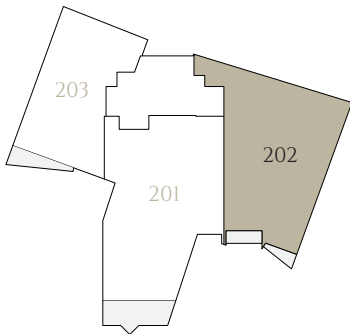

# ASPECT

N I S E K O

## APARTMENT 302

**FLOOR AREA**  
165.37m<sup>2</sup> (inc. 2.79m<sup>2</sup> owner storage)

**BALCONY**  
7.0m<sup>2</sup> (Exclusive use non-saleable area)

**PARKING**  
Non-reserved; subject to availability

**LAYOUT**  
3 bedrooms / 3 bathrooms / 1 Maids room

**VIEWS**  
Mt Yotei



NORTH



MT. YOTEI

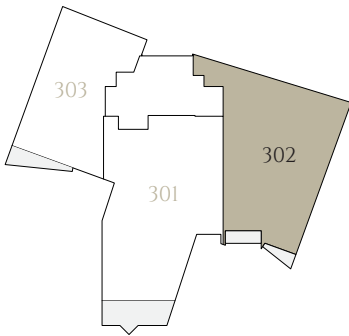

# ASPECT

N I S E K O

## APARTMENT 402

**FLOOR AREA**  
165.65m<sup>2</sup> (inc. 2.37m<sup>2</sup> owner storage)

**BALCONY**  
5.9m<sup>2</sup> (Exclusive use non-saleable area)

**PARKING**  
Non-reserved; subject to availability

**LAYOUT**  
3 bedrooms / 3 bathrooms / 1 Maids room

**VIEWS**  
Mt Yotei



NORTH



MT. YOTEI

